

Observació: per fer la connexió Bluetooth no hi d'haver-hi res connectat a l'entrada AUX (Audio input)



Douk Audio NS-01G Pro 2.0 Channel  
Wireless Bluetooth Digital Power Amplifier

## User Manual

### HOW TO USE

1. Connect the power supply to the amplifier firstly and then plug it into the socket to avoid generating electric sparks.
2. Wireless Input
  - Correctly connect passive speakers to the amplifier output with high-quality cables.
  - Toggle the power switch to turn it on, the indicator will be flashing blue (BT mode).
  - Turn on your audio source's Bluetooth function, search and click to connect. Blue indicator will be always-on after successful connection.
3. Wired Input
  - Correctly connect your audio source to the amp input with AUX cable or USB cable, and connect passive speakers to the amp output.
  - Toggle the power switch to turn it on, and play music with your audio source devices.

### NOTICE

1. Please connect the power supply to the amplifier firstly and then plug it into the socket to avoid electric sparks but still safe and no harm to the amp.
2. If you buy the version with power supply( 12V/5A Max Output 60W), it is enough to drive most home speakers. If you buy the version without power supply, please prepare it (DC9V-24V) by yourself. And bigger and more speakers need higher power supply to drive.

### FRONT PANEL INTRODUCTION

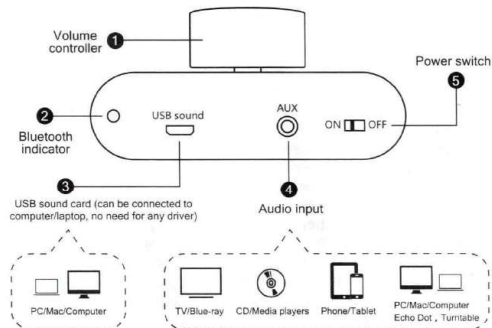

### REAR PANEL INTRODUCTION

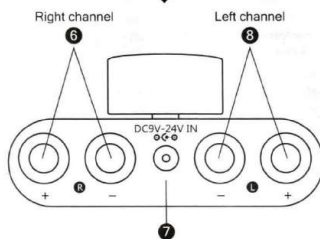

Power input: DC9V-DC24V

This amplifier requires 50W power supply at minimum, its auto power-off during use means that your speaker needs high power supply to drive, please turn down the volume or change another power supply with higher output.

### FREQUENTLY QUESTIONS

#### Q: All cables are connected, but no sound output?

- A: 1. Check if the indicator is on, and turn on the power button or knob if it is not on. If the indicator is still not on after turn on the power, you can find a laptop power and connect to test whether it is the machine fault or a power failure.
2. If the indicator is on, check whether the VOL knob is in the minimum position. If so, turn clockwise to normal volume.
3. If both of the above are normal, check the input device if it is paused, mute, or the volume is minimized.

#### Q: Why there is the sound distortion?

A: When the output power exceeds the normal power of amplifier, there will be a large distortion. you can turn down the preamp volume or the power amplifier volume.

#### Q: Why do loudspeakers make a lot of electric noise?

A: if you are not using the original factory standard power supply, please replace the power supply before testing. Many power supply in the market have large interference coefficient, which will cause a lot of current sound.

#### Q: Why after connecting signal line, there is interferential sound even not play music?

A: if you use unshielded signal lines, there will be interference signals entering the power amplifier. If you hate the noise, please use the shielded signal lines or unplugging the signal lines.

#### Q: Why does the amplifier stop working after a period of time?After a period of time off, it will work again.

A: The amplifier may be overheat protected in this case, and the output power may have exceeded the rated power, so you can turn down the volume and try again.

#### Q: Why does the volume of the machine stay the same, while the sound of different audio sources (such as CDS and mobile phones) is different?

A: The output range of different types of audio source devices is different, the mobile phone is usually 0.35mV, and the CD is 1V. The signal output amplitude of the sound source will directly influence the volume.

#### Q: Why the sound of the power amplifier is not very good at the beginning, the high frequency is not clear, but after working for 8 hours the sound is normal?

A: Speakers and amplifiers are very sensitive equipment, they also need a process to know and match each other, after working together for 8 hours the sound will be good, new power amplifier and new speaker needs more than ten hours.

### CONNECTING TO SPEAKERS INSTRUCTION

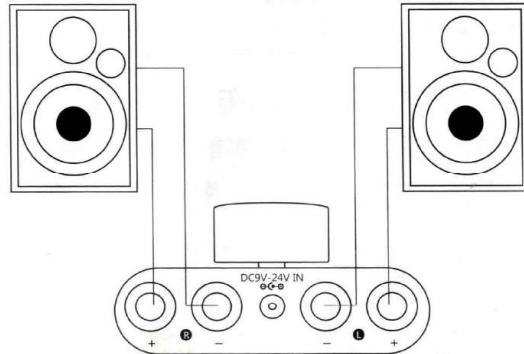

### CONTACT INFORMATION

Address: Room 1329, Wang Cheng Building, Long Guan street,

Long Hua new District, Shenzhen, Guang Dong, China

Contact: LIU CHENXI

Tel: +86-18570015672

Official website: [www.doukaudio.com](http://www.doukaudio.com)

Email: [nobsound@doukaudio.com](mailto:nobsound@doukaudio.com)